

BOULEVARD ARISTIDE BRIAND

ACCÈS PIETONS
+63.38m NGF (-0.02m)

ACCÈS VEHICULES
+63.33m NGF (-0.07m)

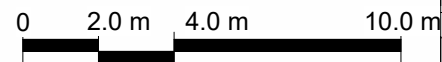
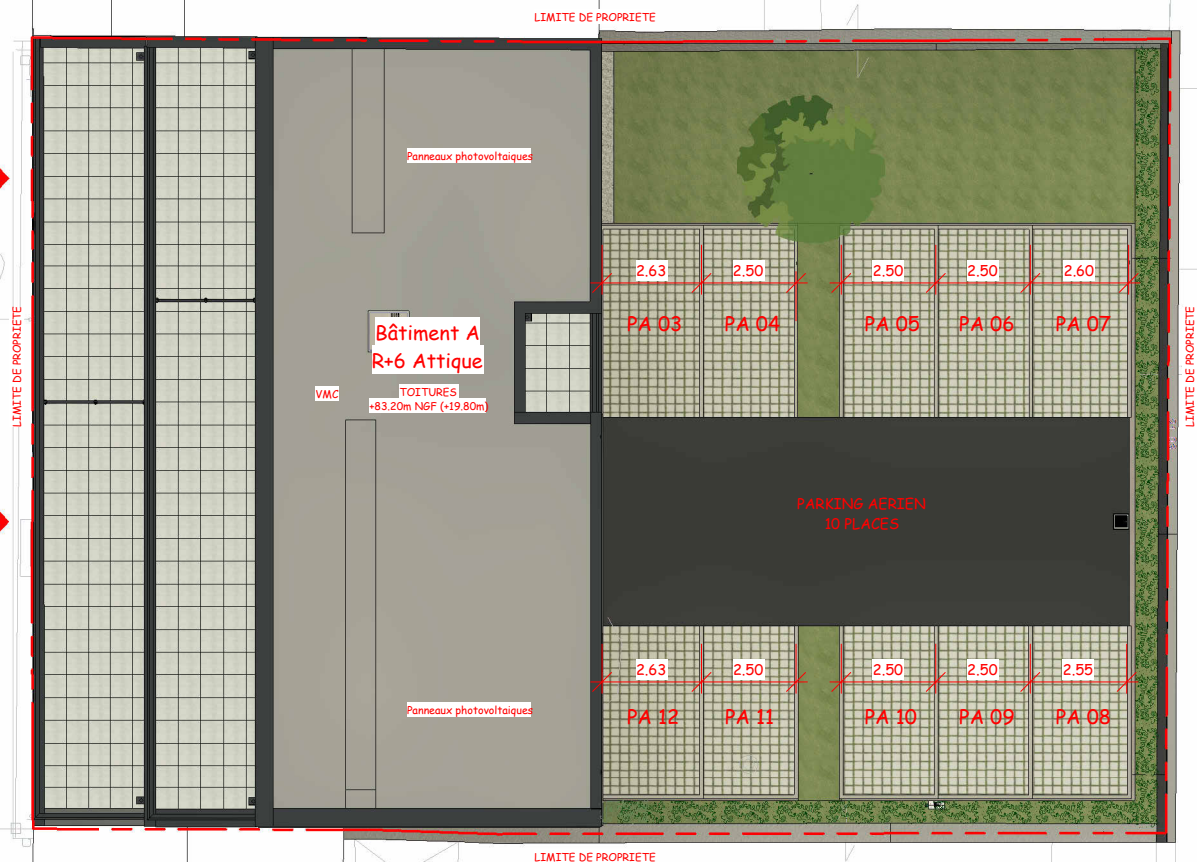

VILLA JOSÉPHINE

Construction d'un immeuble de 25 logements collectifs

137 Boulevard Aristide Briand
85000 LA ROCHE-SUR-YON

NIV.

PLAN MASSE

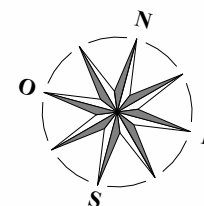

N°	DESCRIPTION	DATE
V1	Série Notaire	08.11.2024

LE RESERVANT :	LE RESERVATAIRE :